

SONY®

4-562-187-E6(1)



Television

Reference Guide

⚠ Before operating the TV, please read this manual thoroughly and retain it for future reference.

产品注册
为了给您提供更多更完善的服务，我们已经开通了“网上产品注册”服务项目，凡购买我们的产品，并上网注册后，您将获更多优惠。

详情请点击
<http://www.sony.com.cn/productclub>

BRAVIA

KD-75X9400C / 65X9300C

Table of Contents

Safety Information	6
Precautions	10
Parts and Controls	13
Controls and Indicators	13
Inputs and Outputs	14
Using Remote Control	17
Remote Control Parts	
Description	17
Using the Touchpad Remote	
Control	19
Launching the Touchpad	
Remote Control Introduction/	
Tutorial	19
Attaching the Table-Top	
Stand (Alternative)	20
Connecting the TV	21
Connecting MHL Device	22
Installing Wall-Mount	
Attachment for Wall-Mount	
Bracket	23
Troubleshooting	25
Troubles and Solutions	26
Specifications	27

Introduction

Thank you for choosing this Sony product.

Note

- Images and illustrations used in Startup Guide and this manual are for reference only and may differ from actual product appearance.

无线相关规定

- ①不得擅自更改发射频率、加大发射功率（包括额外加装射频功率放大器），不得擅自外接天线或改用其它发射天线。
- ②使用时不得对各种合法的无线电业务产生有害干扰；一旦发现有干扰现象时，应立即停止使用，并采取措施消除干扰后方可继续使用。
- ③使用微功率无线电设备，必须忍受各种无线电业务的干扰或工业、科学及医疗应用设备的辐射干扰。
- ④不得在飞机和机场附近使用。
- ⑤该频段的无线接入系统仅限室内使用，且距离同频段的卫星无线电测定（空对地）业务和卫星固定（空对地）业务的地球站大于 3km。

Notes on using Internet features

- You agree to comply with any and all terms and conditions that any content on the Web may require for said content's service and usage.
- Your ability to access Internet content is subject to your Internet provider's service and terms, and your network environment.
- Sony shall have no responsibility for Internet content.

- Sony may add, change, discontinue, remove, or suspend any services or Sony content services, temporarily or permanently, at any time, without notice and without liability.
- By using this feature, you agree to be bound by above terms and conditions.

Location of the identification label

Labels for the Model No. and Power Supply rating are located on the rear of the TV.

产品中有害物质的名称及含量

部件名称	有害物质					
	铅 (Pb)	汞 (Hg)	镉 (Cd)	六价铬 (Cr(VI))	多溴联苯 (PBB)	多溴二苯醚 (PBDE)
实装基板	×	○	○	○	○	○
液晶屏	○	○	○	○	○	○
壳体	×	○	○	○	○	○
扬声器	×	○	○	○	○	○
附属品	×	○	○	○	○	○

本表格依据 SJ/T 11364 的规定编制

○表示该有害物质在该部件所有均质材料中的含量均在 GB/T 26572 规定的限量要求以下。
 ×表示该有害物质至少在该部件的某一均质材料中的含量超出 GB/T 26572 规定的限量要求。

无线局域网功能的主要技术参数及其指标值

频率范围	2.4000 GHz-2.4835 GHz/ 5.15 GHz-5.25 GHz/ 5.25 GHz-5.35 GHz/ 5.725 GHz-5.850 GHz	
频率容限	≤ 20 ppm	
占用带宽	2.4 GHz	≤ 22 MHz
	5 GHz	≤ 80 MHz
发射功率	2.4 GHz	≤ 20 dBm (EIRP)
	5.15 GHz-5.25 GHz	≤ 23 dBm (EIRP)
	5.25 GHz-5.35 GHz	≤ 20 dBm (EIRP)
	5.725 GHz-5.850 GHz	≤ 33 dBm (EIRP)
杂散发射限值	≤ -30 dBm	

蓝牙功能的主要技术参数及其指标值

频率范围	2.4000 GHz-2.4835 GHz
频率容限	≤ 20 ppm
占用带宽	≤ 2 MHz
发射功率	≤ 4 dBm (EIRP)
杂散发射限值	≤ -30 dBm

Safety Information

WARNING

Batteries must not be exposed to excessive heat such as sunshine, fire or the like.

Installation/Set-up

Install and use the TV set in accordance with the instructions below in order to avoid any risk of fire, electrical shock or damage and/or injuries.

Installation

- To avoid slipping and causing personal injury, do not step on the TV protection bag while unpacking the TV set.
- The TV set should be installed near an easily accessible AC power outlet (mains socket).
- Place the TV set on a stable, level surface to avoid it from falling down and cause personal injury or damage to the TV.
- Install the TV where it cannot be pulled, pushed, or knocked over.
- Install the TV so that the TV's Table-Top Stand does not protrudes out from the TV stand (not supplied). If the Table-Top Stand protrudes out from the TV stand, it may cause TV set to topple over, fall down, and cause personal injury or damage to the TV.

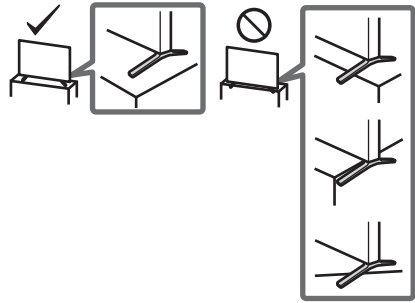

- Only qualified service personnel should carry out wall installations.
 - For safety reasons, it is strongly recommended that you use Sony Wall-Mount Bracket. For details, consult Sony service centre hotline 400 810 9000.
 - Be sure to use the screws supplied with the Wall-Mount Bracket when attaching the Wall-Mount Bracket to the TV set. The supplied screws are designed as indicated by illustration when measured from the attaching surface of the Wall-Mount Bracket.
- The diameter and length of the screws differ depending on the Wall-Mount Bracket model. Use of screws other than those supplied may result in internal damage to the TV set or cause it to fall, etc.

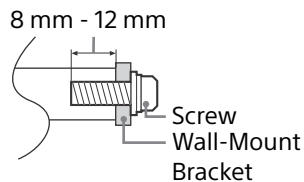

For product protection and safety reasons, Sony strongly recommends that you use the Wall-Mount Bracket model designed for your TV and the wall-mounting of your TV should be performed by Sony dealers or licensed contractors.

Transporting

- Before transporting the TV set, disconnect all cables.
- Two or three people are needed to transport a large TV set.
- When transporting the TV set by hand, hold it as shown below. Do not put stress on the LCD panel and the frame around the screen.

KD-75X9400C

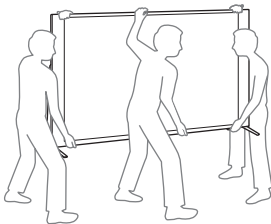

KD-65X9300C

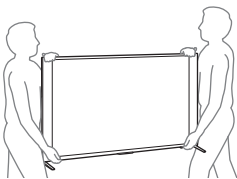

- When transporting the TV set, do not subject it to jolts or excessive vibration.
- When transporting the TV set for repairs or when moving, pack it using the original carton and packing material.

Ventilation

- Never cover the ventilation holes or insert anything in the cabinet.
- Leave space around the TV set as shown below.
- It is strongly recommended that you use a Sony Wall-Mount Bracket in order to provide adequate air circulation.

Installed on the wall

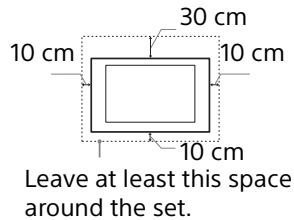

Installed with stand

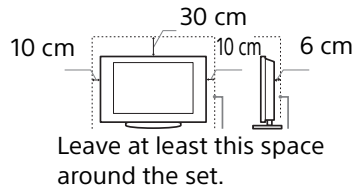

- To ensure proper ventilation and prevent the collection of dirt or dust:
 - Do not lay the TV set flat, install upside down, backwards, or sideways.
 - Do not place the TV set on a shelf, rug, bed or in a closet.
 - Do not cover the TV set with a cloth, such as curtains, or items such as newspapers, etc.
 - Do not install the TV set as shown below.

Air circulation is blocked.

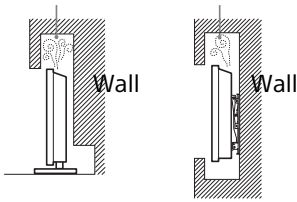

AC power cord (Mains lead)

Handle the AC power cord (mains lead) and outlet (mains socket) as follows in order to avoid any risk of fire, electrical shock or damage and/or injuries:

- Insert the plug fully into the AC power outlet (mains socket).
- Operate the TV set on a 220 V AC supply only.
- When wiring cables, be sure to unplug the AC power cord (mains lead) for your safety and take care not to catch your feet on the cables.
- Disconnect the AC power cord (mains lead) from the AC power outlet (mains socket) before working on or moving the TV set.
- Keep the AC power cord (mains lead) away from heat sources.
- Unplug the AC power plug (mains plug) and clean it regularly. If the plug is covered with dust and it picks up moisture, its insulation may deteriorate, which could result in a fire.

Note

- Do not pinch, bend, or twist the AC power cord (mains lead) excessively. The core conductors may be exposed or broken.
- Do not modify the AC power cord (mains lead).

- Do not put anything heavy on the AC power cord (mains lead).
- Do not pull on the AC power cord (mains lead) itself when disconnecting the AC power cord (mains lead).
- Do not connect too many appliances to the same AC power outlet (mains socket).
- Do not use a poor fitting AC power outlet (mains socket).

Prohibited Usage

Do not install/use the TV set in locations, environments or situations such as those listed below, or the TV set may malfunction and cause a fire, electrical shock, damage and/or injuries.

Location:

- Outdoors (in direct sunlight), at the seashore, on a ship or other vessel, inside a vehicle, in medical institutions, unstable locations, near water, rain, moisture or smoke.
- If the TV is placed in the changing room of a public bath or hot spring, the TV may be damaged by airborne sulphur, etc. 
- For best picture quality, do not expose the screen to direct illumination or sunlight.
- Avoid moving the TV from a cold area to a warm area. Sudden room temperature changes may cause moisture condensation. This may cause the TV to show poor picture and/or poor colour. Should this occur, allow moisture to evaporate completely before powering the TV on.

Environment:

- Places that are hot, humid, or excessively dusty; where insects may enter; where it might be exposed to mechanical vibration, near flammable objects (candles, etc). The TV set shall not be exposed to dripping or splashing and no objects filled with liquids, such as vases, shall be placed on the TV.
- Do not place the TV in a humid or dusty space, or in a room with oily smoke or steam (near cooking tables or humidifiers). Fire, electric shock, or warping may result.
- Do not install the TV in places subject to extreme temperature such as in direct sunlight, near a radiator or a heating vent. The TV may overheat in such condition which can cause deformation of the enclosure and/or TV malfunction.



Situation:

- Do not use when your hands are wet, with the cabinet removed, or with attachments not recommended by the manufacturer. Disconnect the TV set from AC power outlet (mains socket) and antenna (aerial) during lightning storms.

- Do not install the TV so that it sticks out into an open space. Injury or damage from a person or object bumping into the TV may result.

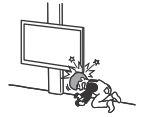

Broken pieces:

- Do not throw anything at the TV set. The screen glass may break by the impact and cause serious injury.
- If the surface of the TV set cracks, do not touch it until you have unplugged the AC power cord (mains lead). Otherwise electric shock may result.

When not in use

- If you will not be using the TV set for several days, the TV set should be disconnected from the AC power (mains) for environmental and safety reasons.
- As the TV set is not disconnected from the AC power (mains) when the TV set is just turned off, pull the plug from the AC power outlet (mains socket) to disconnect the TV set completely.
- However, some TV sets may have features that require the TV set to be left in standby to work correctly.

For children

- Do not allow children to climb on the TV set.
- Keep small accessories out of the reach of children, so that they are not mistakenly swallowed.

Handling of the batteries

The batteries should keep away from children. If child swallowed the batteries, consult to doctor immediately.

Outer case broken battery should not contact to water.

If the following problems occur...

Turn off the TV set and unplug the AC power cord (mains lead) immediately if any of the following problems occur.

Ask your dealer or Sony service centre to have it checked by qualified service personnel.

When:

- AC power cord (mains lead) is damaged.
- Poor fitting of AC power outlet (mains socket).
- TV set is damaged by being dropped, hit or having something thrown at it.
- Any liquid or solid object falls through openings in the cabinet.

About LCD Monitor Temperature

When the LCD Monitor is used for an extended period, the panel surrounds become warm. You may feel hot when touching there by the hand.

Precautions

Viewing the TV

- Some people may experience discomfort (such as eye strain, fatigue, or nausea) while watching 3D video images or playing stereoscopic 3D games. Sony recommends that all viewers take regular breaks while watching 3D video images or playing stereoscopic 3D games. The length and frequency of necessary breaks will vary from person to person. You must decide what works best. If you experience any discomfort, you should stop watching the 3D video images or playing stereoscopic 3D games until the discomfort ends; consult a doctor if you believe necessary. You should also review (i) the instruction manual of any other device or media used with this television and (ii) our website (<http://www.sony.com.cn>) for the latest information. The vision of young children (especially those under six years old) is still under development. Consult your doctor (such as a paediatrician or eye doctor) before allowing young children to watch 3D video images or play stereoscopic 3D games. Adults should supervise young children to ensure they follow the recommendations listed above.
- Do not use, store, or leave the 3D Glasses or battery near a fire, or in places with a high temperature, e.g., in direct sunlight, or in sun-heated cars.

- View the TV in moderate light, as viewing the TV in poor light or during long period of time, strains your eyes.
- When using headphones, adjust the volume so as to avoid excessive levels, as hearing damage may result.

LCD Screen

- Although the LCD screen is made with high-precision technology and 99.99% or more of the pixels are effective, black dots may appear or bright points of light (red, blue, or green) may appear constantly on the LCD screen. This is a structural property of the LCD screen and is not a malfunction.
- Do not push or scratch the front filter, or place objects on top of this TV set. The image may be uneven or the LCD screen may be damaged.
- If this TV set is used in a cold place, a smear may occur in the picture or the picture may become dark. This does not indicate a failure. These phenomena disappear as the temperature rises.
- Ghosting may occur when still pictures are displayed continuously. It may disappear after a few moments.
- The screen and cabinet get warm when this TV set is in use. This is not a malfunction.
- The LCD screen contains a small amount of liquid crystal. Follow your local ordinances and regulations for disposal.

Handling and cleaning the screen surface/cabinet of the TV set

Be sure to unplug the AC power cord (mains lead) connected to the TV set from AC power outlet (mains socket) before cleaning.

To avoid material degradation or screen coating degradation, observe the following precautions.

- To remove dust from the screen surface/cabinet, wipe gently with a soft cloth. If dust is persistent, wipe with a soft cloth slightly moistened with a diluted mild detergent solution.
- Never spray water or detergent directly on the TV set. It may drip to the bottom of the screen or exterior parts and enter the TV set, and may cause damage to the TV set.
- Never use any type of abrasive pad, alkaline/acid cleaner, scouring powder, or volatile solvent, such as alcohol, benzene, thinner or insecticide. Using such materials or maintaining prolonged contact with rubber or vinyl materials may result in damage to the screen surface and cabinet material.
- Periodic vacuuming of the ventilation openings is recommended to ensure to proper ventilation.
- When adjusting the angle of the TV set, move it slowly so as to prevent the TV set from moving or slipping off from its table stand.



Optional Equipment

- Keep optional components or any equipment emitting electromagnetic radiation away from the TV set. Otherwise picture distortion and/or noisy sound may occur.

Wireless Function of the unit

- Do not operate this unit near medical equipment (pacemaker, etc.), as malfunction of the medical equipment may result.
- Although this unit transmits/ receives scrambled signals, be careful of unauthorised interception. We cannot be responsible for any trouble as a result.

Caution about handling the remote control

- When replacing the battery, set the polarity correctly. Do not short, re-charge, force discharge, mixing old and new batteries. Prohibit soldering, disassembling, heating and putting in fire. Remove empty battery from the product immediately.
- Dispose of batteries in an environmentally friendly way. Certain regions may regulate the disposal of batteries. Please consult your local authority.
- Handle the remote control with care. Do not drop or step on it, or spill liquid of any kind onto it.
- Do not place the remote control in a location near a heat source, a place subject to direct sunlight, or a damp room.

Parts and Controls

Controls and Indicators

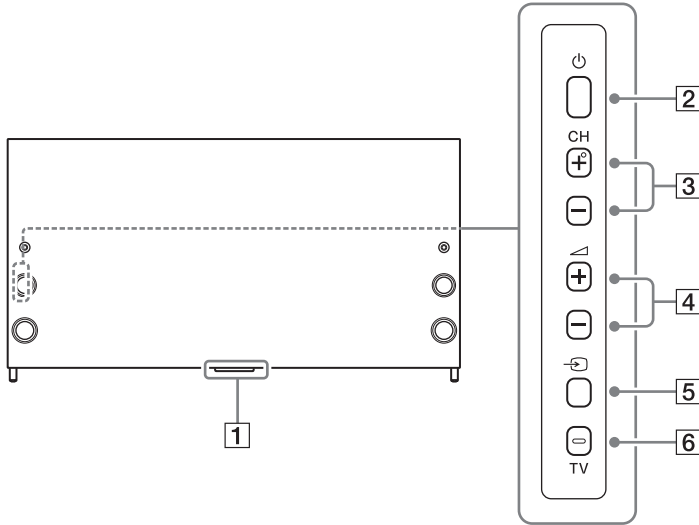

1 Remote Control sensor* / Light sensor* / Illumination LED / 3D Sync Transmitter*

The illumination LED lights up or blinks according to the status of the TV.

- White
When turning on the TV/picture off mode/software update, etc.
- Cyan
When connecting with a mobile device wirelessly.
- Amber
Timer is set.

2  (Power)

3 CH +/- (Channel)

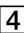
4  +/- (Volume)

5  (Input select)

Display and select the input source.

6 TV

Switch to a TV channel or input from other applications.

* Do not place anything near the sensor.

Inputs and Outputs

KD-75X9400C

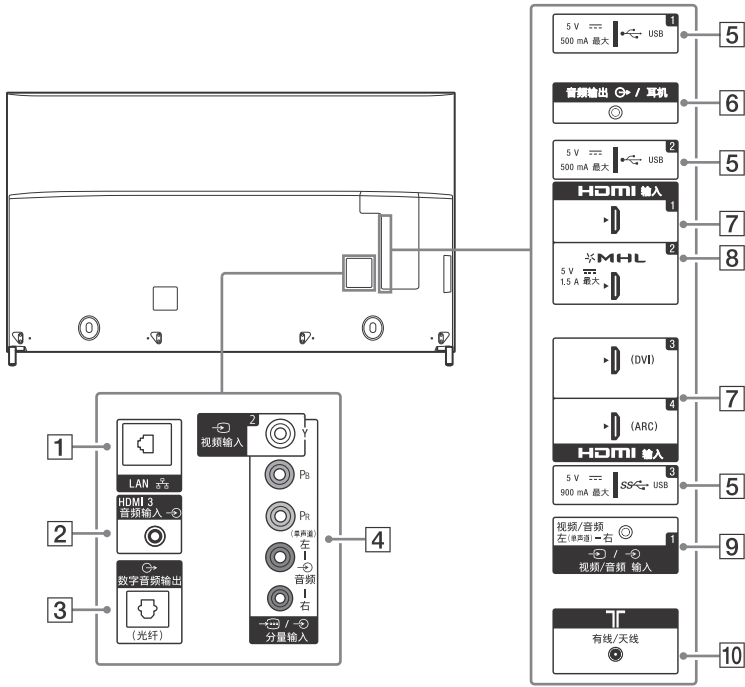

KD-65X9300C

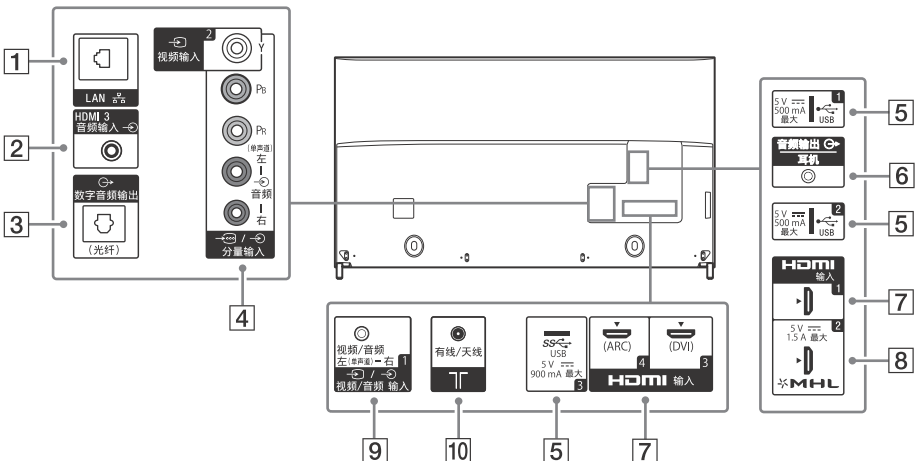





1 LAN

2 HDMI 3 音频输入

For HDMI 3 analogue audio connection.

3 数字音频输出（光纤）

4 视频输入 2, / 分量输入

- For a composite connection:
Use VIDEO IN 2, and  (L/R) of  /  COMPONENT IN*.
- For a component connection:
Use Y, PB, PR, and  (L/R).

5 (USB 1/2), (USB 3)

- Connecting a large USB device may interfere with other connected devices beside it.
- When connecting a large USB device, connect to the USB 1 jack.

6 音频输出 / 耳机

To listen to the TV's sound through the connected equipment, press 主菜单 . Select [Settings] → [Sound] → [Headphone/Audio out] and then select the desired item.

7 HDMI 输入 1/3/4

- If the device has a DVI jack, connect it to HDMI 输入 3 through a DVI - HDMI adaptor interface (not supplied), and connect the device's audio out jack to HDMI 3 音频输入 .
- If connecting a digital audio system that is compatible with Audio Return Channel (ARC) technology, use HDMI 输入 4. If not, an additional connection with 数字音频输出（光纤） is necessary.

8 HDMI 输入 2/MHL

You can connect your MHL (Mobile High-definition Link) device using an HD quality MHL cable.

9 / 视频 / 音频输入 1

For a composite connection, use the supplied Analogue Extension Cable*.

10 有线 / 天线

Connect to your cable or antenna (aerial).

* When connecting mono equipment, connect to the 左 (单声道) audio jack.

Picture Quality

- AV composite cable
- Antenna (aerial) cable
- Component cable
- HDMI cable



Standard definition (SD) videos have picture signals with a vertical resolution of 480 (NTSC) or 576 (PAL/SECAM) lines.



High definition (HD) videos have picture signals with a vertical resolution of 720 or 1,080 lines. (For 4K vertical resolution: 2,160 lines)

Using Remote Control

Remote Control Parts Description

IR (infrared) Remote Control

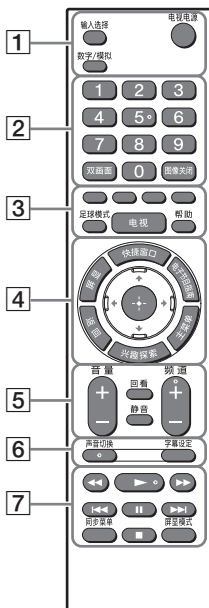

1 输入选择

Display and select the input source.

电视电源

Turn on or turn off the TV (standby mode).

数字 / 模拟

Switch between digital and analogue mode.

Touchpad Remote Control

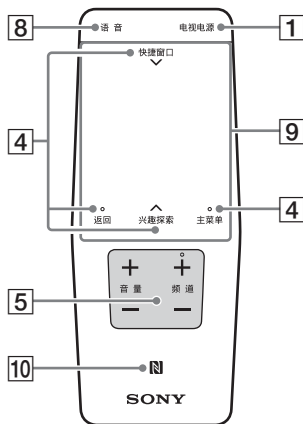

2 Number buttons

双画面 *1*2

Display two pictures simultaneously.

图象关闭

Turn picture off, and sound remains on.

3 Colour buttons

Execute correspondent function at that time.

足球模式

Turn Live Football Mode on or off (when the feature is available).

电视

Switch to a TV channel or input from other applications.

帮助

Display Help Menu.

4 快捷窗口

Display a list of contextual functions.

You can also display it by slide down your finger from 快捷窗口 on the Touchpad Remote Control.

屏显

Display information.

电子节目指南 *1

Display the digital programme guide.

返回

Return to previous screen.

主菜单

Display the TV Home Menu.

兴趣探索

Bring up the Content Bar to search for content.

You can also launch Content Bar by slide up your finger from 兴趣探索 on the Touchpad Remote Control.

▲/▼/←/→/⊕ (Item select/Enter)

5 音量 +/-

Adjusts volume.

回看

Jump back and forth between two channels or inputs. The TV alternates between the current channel or input and the last channel or input that was selected.

静音

Mute the sound. Press again to restore the sound.

频道 +/-

Select the channel.

6 声音切换

Change the language for the programme currently being viewed.

字幕设定

Turn subtitles on or off (when the feature is available).

7 ◀◀/▶▶/▶▶/▶▶/▶▶/▶▶/▶▶/▶▶

Operate media contents on TV and connected BRAVIA Sync-compatible device.

同步菜单

Display the BRAVIA Sync Menu.

屏显模式

Change the screen format.

8 语音 (Microphone)

Use Voice Function. (e.g., Search various content by voice.)

9 Touchpad

Operate the TV with the touchpad.

10 (NFC)

Touch the device (e.g. some models of Xperia) corresponding to the One-touch mirroring function, then its screen is displayed on the TV.

- *1 The location, availability and function of remote control button may vary depending on your country/region/TV model.
- *2 Twin Picture function will be available when software is updated, please contact Sony China customer hotline 400 810 9000 for specific date. You will receive Twin Picture function automatically as a network software upgrade. Make sure your TV is connected to the Internet. If you do not have a network connection, you will be able to download the software from the Sony support website using your PC. For details on how to upgrade, please visit the Sony support website service.sony.com.cn.

Using the Touchpad Remote Control

Touchpad Remote Control can only be used after pairing with the TV. To pair, follow the pairing screen instruction.

Pairing screen can be displayed by pressing the  button on the TV for 5 seconds, or select [Settings] - [Touchpad Remote Control settings] - [Pair Touchpad Remote Control].

Launching the Touchpad Remote Control Introduction/Tutorial

1 Press 主菜单 .

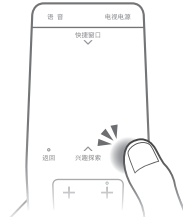

2 Select [Settings] - [Touchpad Remote Control settings] - [Start Introduction/Tutorial].

Attaching the Table-Top Stand (Alternative)

You can change the Table-Top Stand from the edge to the middle position by referring to the instructions below.

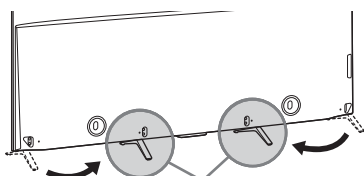

Middle position

Note

- Two or more people are needed to carry out this installation.
- Be careful not to pinch the finger during installation.

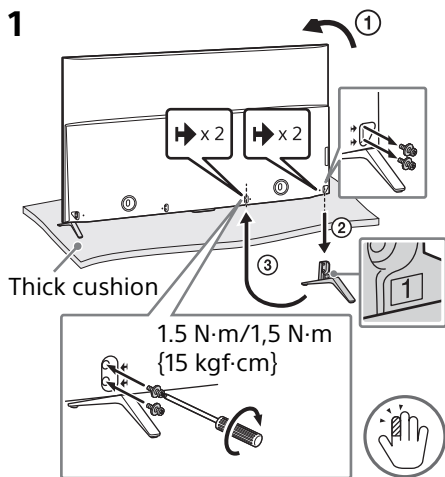

2

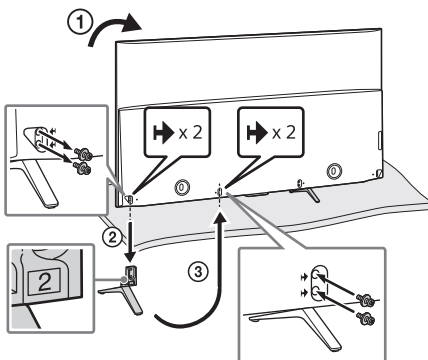

Note

- Two or more people are needed to carry out this installation.
- Ensure that there are no objects in front of the TV.

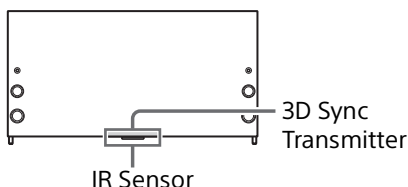

To bundle the cables

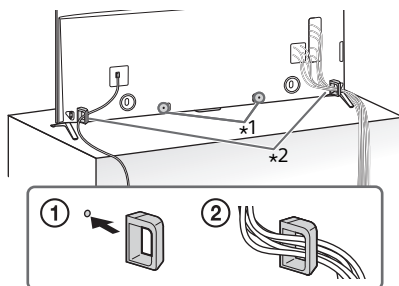

*1 Location of cable clammer when the Table-Top Stand is attached to middle position.

*2 Location of cable clammer when the Table-Top Stand is attached to edge position.

Note

- To detach the cable clamber from the TV, press the top of the clamber ①, then pinch ② as illustrated.

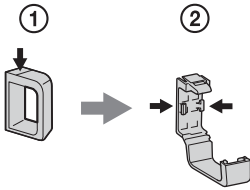

Connecting the TV

Note

- 在将电视机与有线网络连接时，请务必在天线电缆与有线网络端子之间接入随机提供的天线隔离器。否则可能会引起着火等危险。
- 如果有线网络端子的形状特殊、无法与天线隔离器连接，请另行购买可将二者匹配的转接头连接使用。
- To select an input device connected to the TV, press 输入选择 .

■ Detaching the terminal cover

The terminal cover is factory-attached to the TV.

Before connecting cables, remove the terminal cover.

KD-75X9400C

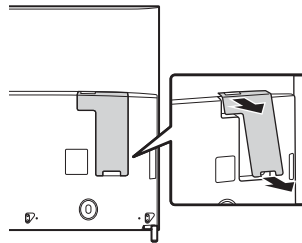

KD-65X9300C

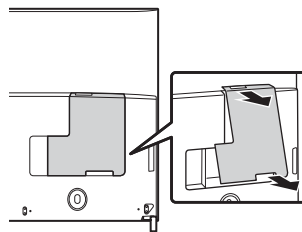

Note

- After connecting all cables, re-attach the terminal cover to the TV.

Connecting MHL Device

KD-75X9400C

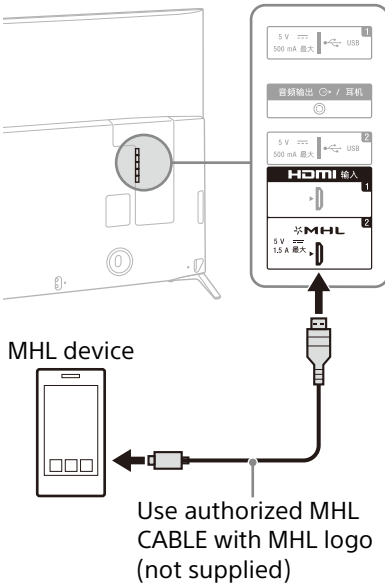

The TV simultaneously charges the MHL-compatible connected device while playing album/music/video files. You can use the TV remote control to control the connected MHL-compatible device.

Note

- If [MHL charging during standby] is set to [On], you can continue charging the MHL-compatible device even when the TV is in standby mode.
- Use authorized MHL 3 CABLE with MHL logo for 4K smartphone or mobile devices.

KD-65X9300C

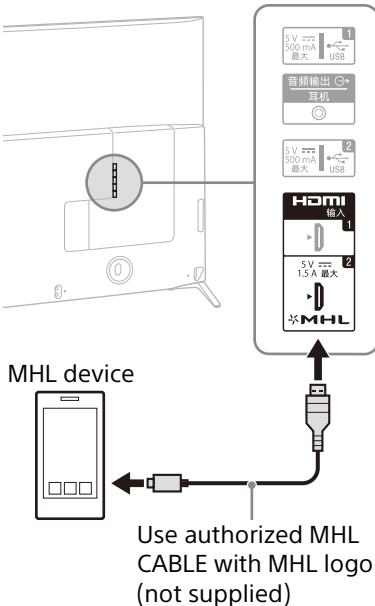

Installing Wall-Mount Attachment for Wall-Mount Bracket

Installing of Wall-Mount Attachment is necessary depending on the Wall-Mount Bracket model. For details, consult Sony service centre.

Note

- Be sure to store the removed screws in a safe place, keeping them away from children.

1 Remove the screws from the rear of the TV.

KD-75X9400C

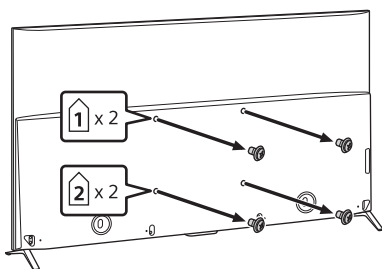

KD-65X9300C

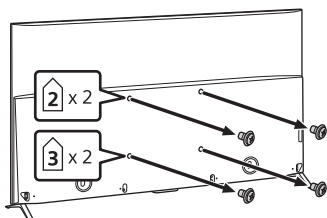

2 Before installing the Wall-Mount Bracket, attach the Wall-Mount Attachment (supplied with the TV) to the rear of the TV (to make it parallel with the wall).

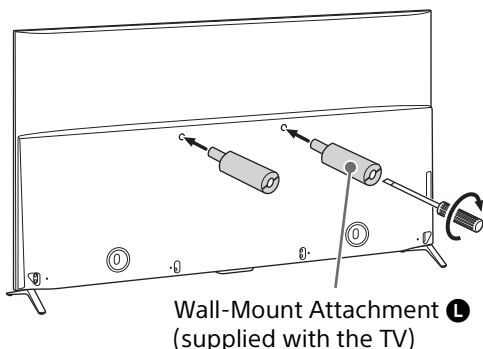

Note

- Be sure to fasten the Wall-Mount Attachment when attaching them to the TV. Use only a flat head screwdriver to install the Wall-Mount Attachment. Use of another tool might result in over torquing the Wall-Mount Attachment and damaging the TV.
- If using an electric screwdriver, set the torque at approximately 1.5 N·m {15 kgf·cm}.
- You cannot use some of the terminals on the rear of the TV depending on the Wall-Mount Bracket model used.
- Connect the Analogue Extension Cable (supplied with the TV) if you need to use the 视频 / 音频输入 1.

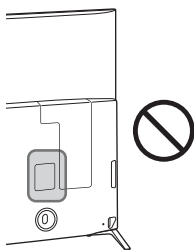

For product protection and safety reasons, Sony strongly recommends that you use the Wall-Mount Bracket model designed for your TV and the wall-mounting of your TV should be performed by Sony dealers or licensed contractors.

Troubleshooting

In order to keep your TV software up-to-date, it is necessary to download the latest software information via the digital broadcasting system or internet and to update the software. Select [Update Now] to start a software update. The illumination LED flashes white while the software is updating. Do not unplug the AC power cord (mains lead) during the software update. If you do, the software update may not finish completely, and it may cause a software malfunction. Software updates can take up to 30 minutes. If you do not wish to update the software automatically, press 主菜单 and select [Help] → [System software update] → [Automatic software download] → [Off].

When you unplug the TV and plug it in again, the TV may not be able to turn on for a while even if you press 电视电源 on the remote control or  on the TV because it takes time to initialize the system. Wait for about 10 to 20 seconds, then operate it again.

When the illumination LED is flashing red, count how many times it flashes (interval time is three seconds).

If the illumination LED flashes red, reset the TV by disconnecting the AC power cord (mains lead) for two minutes, then turn on the TV. If the problem persists, contact your dealer or Sony service centre with the number of times the illumination LED flashes red (interval time is three seconds). Disconnect the AC power cord (mains lead), and inform your dealer or Sony service centre.

When the illumination LED is not flashing, check the items as follows.

You can also refer to [Troubleshooting] in the Help Guide or perform self-diagnosis by selecting [Help] → [Self diagnostics]. If the problem persists, have your TV serviced by qualified service personnel.

Troubles and Solutions

There is no picture (screen is dark) and no sound.

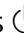
- Check the antenna (aerial)/ cable connection.
- Connect the TV to AC power (mains), and press  on the TV or 电视电源 on the remote control.

Some programmes cannot be tuned.

- Check the antenna (aerial)/ cable connection.

The remote control does not function.

- Replace the batteries.

The [Parental lock] password has been forgotten.



- Enter 9999 for the PIN code. (PIN code 9999 is always accepted.)

The TV surrounds become warm.

- When the TV is used for an extended period, the TV surrounds become warm. You may feel hot when touching there by the hand.

Frozen audio or video, a blank screen, or the TV does not respond to TV or remote control buttons.

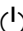
- Perform a simple reset of the TV by unplugging the AC power cord (mains lead) for two minutes, then plug it in again.

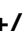
The , CH+/-, ,  and TV buttons cannot be located on the TV.

- See below illustration for location of the buttons on the TV.

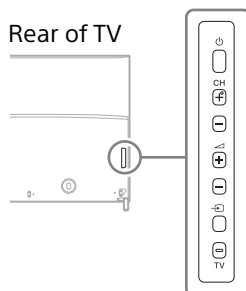

The illumination LED is turned on.

- If you do not wish to light up the illumination LED, you can turn it off. Press 主菜单, then select [Settings] → [Illumination LED] → [Off].

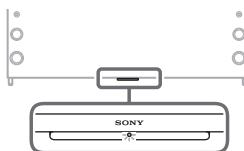

Cannot connect to a wireless router by WPS (Wi-Fi Protected Setup).

- If you use WEP security, select [Easy] → [Wi-Fi] → [Connect by scan list]. Then, select the network name (SSID) you want to connect.

Cannot find the required network name in network setup.

- Select [[Manual entry]] and press ⊕ to enter network name.

Specifications

System

Panel system

LCD (Liquid Crystal Display) Panel,
LED Backlight (Edge LED):
KD-65X9300C, Direct LED:
KD-75X9400C)

TV system

Analogue: D/K, I, B/G, M
Digital: GB20600-2006/DVB-C*

Colour system/video system

Analogue: PAL, SECAM, NTSC4.43,
NTSC3.58
Digital: Refer to the Help Guide

Channel coverage

Analogue: VHF/UHF/Cable
Digital: GB20600-2006/DVB-C*

Sound output

10 W + 10 W + 10 W + 10 W + 16 W +
16 W (at 7 % distortion)

Wireless technology



Protocol IEEE802.11ac/a/b/g/n
Bluetooth Version 4.1



- * This function may not work due to different cities, please contact Sony China hotline 400 810 9000 for details.

Input/Output jacks

Antenna (aerial)/Cable

75 ohm external terminal for VHF/
UHF

 /  VIDEO/AUDIO IN 1
Video/Audio input (mini jack)

 /  COMPONENT IN
YP_BP_R (Component Video): 1080p
(50, 60 Hz), 1080i (50, 60 Hz), 720p
(50, 60 Hz), 576p, 576i, 480p, 480i
Audio input (phono pin jack)

VIDEO IN 2

Video input (common phono pin with Y input)

HDMI IN 1, 2, 3, 4 (Support 4K resolution)

Video (2D):

4096 × 2160p (50, 60 Hz)^{*1*2},
4096 × 2160p (24 Hz)^{*2},
3840 × 2160p (50, 60 Hz)^{*1},
3840 × 2160p (24, 25, 30 Hz),
1080p (30, 50, 60 Hz), 1080/24p,
1080i (50, 60 Hz), 720p (30, 50,
60 Hz), 720/24p, 576p, 576i, 480p,
480i, PC Formats

^{*1} YCbCr 4:2:0 / 8bit only

^{*2} 3840 × 2160p is displayed when
4096 × 2160p is input

Video (3D):

Frame Packing: 1080p (30 Hz),
1080/24p, 1080i (50, 60 Hz), 720p
(30, 50, 60 Hz), 720/24p

Side-by-Side: 1080p (50, 60 Hz),
1080/24p, 1080i (50, 60 Hz), 720p
(50, 60 Hz)

Over-Under: 1080p (30, 50, 60 Hz),
1080/24p, 1080i (50, 60 Hz), 720p
(50, 60 Hz)

Audio: 5.1 channel linear PCM: 32,
44.1, 48, 88.2, 96, 176.4 and
192 kHz, 16, 20 and 24 bits, Dolby
Digital and DTS

ARC (Audio Return Channel) (HDMI
IN 4 only)

MHL (HDMI IN 2)

Video (2D):

4096 × 2160p (24 Hz)^{*}, 3840 ×
2160p (24, 25, 30 Hz), 1080p (30,
50, 60 Hz), 1080/24p, 1080i (50,
60 Hz), 720p (30, 50, 60 Hz), 720/
24p, 576p, 576i, 480p, 480i

^{*} 3840 × 2160p is displayed when
4096 × 2160p is input

Video (3D):

Frame Packing: 1080p (30 Hz),
1080/24p, 1080i (50, 60 Hz), 720p
(30, 50, 60 Hz), 720/24p

Side-by-Side: 1080p (50, 60 Hz),
1080/24p, 1080i (50, 60 Hz), 720p
(50, 60 Hz)

Over-Under: 1080p (50, 60 Hz),
1080p (30 Hz), 1080/24p, 1080i
(50, 60 Hz), 720p (50, 60 Hz)

Audio: 5.1 channel linear PCM: 32,
44.1, 48, 88.2, 96, 176.4 and
192 kHz, 16, 20 and 24 bits, Dolby
Digital and DTS

DIGITAL AUDIO OUT (OPTICAL)

Digital optical jack (Two channel
linear PCM, Dolby Digital, DTS)

HDMI 3 AUDIO IN

Analogue audio input (Stereo mini
jack)

AUDIO OUT /Headphone (stereo mini jack)

Headphone, Audio Output,
Subwoofer

USB 1, 2, SS USB 3

USB port 1 and 2 support High
Speed USB (USB 2.0).

USB port 3 supports Super Speed
USB (USB 3.0).

LAN

10BASE-T/100BASE-TX connector
(Depending on the operating environment of the network, connection speed may differ. 10BASE-T/100BASE-TX communication rate and communication quality are not guaranteed for this TV.)

Others

Optional accessories

Wireless Subwoofer: SWF-BR100
MHL Cable: DLC-MC30
4K media player: FMP-X10
Camera and Microphone Unit: CMU-BR300
Active 3D Glasses: TDG-BT500A



Product usage condition

Environment temperature

5 °C – 35 °C

Humidity

20 % – 80 %

Air pressure

86 kPa – 106 kPa

Power and others

Power requirements

220 V AC, 50 Hz

Viewing screen size (diagonal)

(Approx.)

KD-75X9400C: 189.3 cm (75 inch)

KD-65X9300C: 163.9 cm (65 inch)

Display resolution

3,840 dots (horizontal) × 2,160 lines
(vertical)

Power consumption

KD-75X9400C: 478 W

KD-65X9300C: 299 W

能效等级 *1

3 级

Standby Power Consumption*1 *2

Below than 0.5 W

Dimensions (Approx.) (w × h × d)

with Table-Top Stand

Edge position:

KD-75X9400C: 1,929 × 1,041 ×
322 mm

KD-65X9300C: 1,706 × 911 ×
292 mm

Middle position:

KD-75X9400C: 1,929 × 1,048 ×
322 mm

KD-65X9300C: 1,706 × 919 ×
292 mm

without Table-Top Stand

KD-75X9400C: 1,929 × 991 × 110 mm

KD-65X9300C: 1,706 × 871 × 90 mm

Stand width (Approx.)

Edge position:

KD-75X9400C: 1,910 mm

KD-65X9300C: 1,690 mm

Middle position:

KD-75X9400C: 707 mm

KD-65X9300C: 607 mm

Mass (Approx.)

with Table-Top Stand

KD-75X9400C: 56.8 kg

KD-65X9300C: 48.0 kg

without Table-Top Stand

KD-75X9400C: 56.0 kg

KD-65X9300C: 47.3 kg

*1 根据 GB 24850-2013 《平板电视能效限定值及能效等级》的规定。待机消耗功率是等电视机完成所需的内部处理达到稳定后的值。

*2 Standby power consumption will increase when your TV is connected to the network.

Note

- Optional accessories availability depends on countries/region/TV model/stock.
- Design and specifications are subject to change without notice.
- 产品的能效指数详见能效标识。
- This TV set incorporates MHL 3.

Trademark information

- The terms HDMI and HDMI High-Definition Multimedia Interface, and the HDMI Logo are trademarks or registered trademarks of HDMI Licensing LLC in the United States and other countries.
- Manufactured under license from Dolby Laboratories. Dolby and the double-D symbol are trademarks of Dolby Laboratories.
- “BRAVIA” and BRAVIA are trademarks of Sony Corporation.
- Gracenote, Gracenote eyeQ, Gracenote VideoID, Gracenote Video Explore, the Gracenote logo and logotype, and the “Powered by Gracenote” logo are either registered trademarks or trademarks of Gracenote in the United States and/or other countries.
- Opera® Devices SDK from Opera Software ASA. Copyright 1995-2014 Opera Software ASA. All rights reserved.
- Wi-Fi, Wi-Fi Direct, Miracast and Wi-Fi Protected Setup are trademarks or registered trademarks of Wi-Fi Alliance.
- MHL, Mobile High-Definition Link and the MHL Logo are trademarks or registered trademarks of MHL Licensing, LLC.
- For DTS patents, see <http://patents.dts.com>. Manufactured under license from DTS, Inc. DTS, the Symbol, & DTS and the Symbol together are registered trademarks, and DTS Digital Surround is a trademark of DTS, Inc. © DTS, Inc. All Rights Reserved.
- Designed with UEI Technology™ Under License from Universal Electronics Inc. Portions © UEI 2000 – 2014
- The Bluetooth® word mark and logos are owned by the Bluetooth SIG, Inc. and any use of such marks by Sony Corporation is under license. Other trademarks and trade names are those of their respective owners.
- © 2015 RealNetworks, Inc. Patents Pending. All rights reserved. RealNetworks logo is a trademark of RealNetworks, Inc.
- USB-IF SuperSpeed USB Trident logo is a registered trademark of USB Implementers Forum, Inc. 
- TUXERA is a registered trademark of Tuxera Inc. in the US and other countries.
- The N Mark is a trademark or registered trademark of NFC Forum, Inc. in the United States and in other countries.



4K
实际分辨率：
3840 x 2160



制造商:

上海索广映像有限公司

上海市浦东新区川沙路 3777 号

邮编: 201201

产品标准号: Q31/0115000076C008-2015

产品标准号若有变更, 请以产品外包装标注为准



Customer Support and Contact:

<http://service.sony.com.cn/TV/index.htm>

<http://www.sony.com.cn/>

出版日期: 2015 年 9 月