



立体声耳机

使用说明书

Stereo Headphones

Operating Instructions

MDR-PQ4

©2010 索尼公司 泰国印刷

©2010 Sony Corporation Printed in Thailand



A

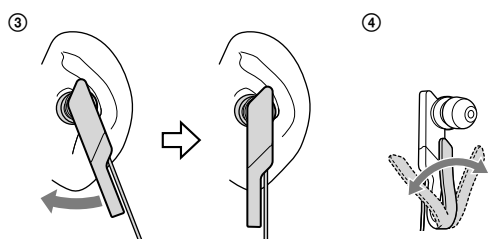

B

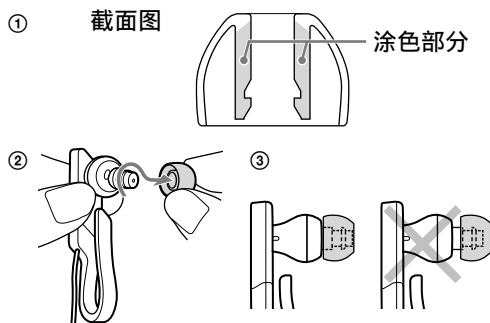

C

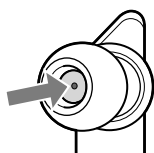

简体中文

立体声耳机

使用产品前请仔细阅读本使用说明书，并请妥善保管。

特点

- 适合稳定佩戴的耳夹设计。
- 钹磁呈现清晰且强劲音效。
- 佩戴舒适、稳定的混合硅胶耳塞。
- 导线滑动器可防止导线缠绕。

如何使用

佩戴耳机（见图 A）

- 1 将标有Ⓜ的耳塞戴在右耳，将标有Ⓛ的耳塞戴在左耳（见图 A-①）。
- 2 将耳机挂在耳朵周围（见图 A-②）。标有Ⓛ的耳机上有一个触觉点，表示左边。
- 3 转动耳机夹住耳垂周围（见图 A-③）。
- 4 调整耳塞，使其舒适地贴合耳朵。如图（A-④）所示移动耳夹，使佩戴舒适。

如何使用导线滑动器（见图 A-①）

上下移动改变导线的开叉位置。耳机使用后，请将导线滑动器保持在高位，以免导线缠绕。

如何正确安装耳塞（见图 B）

如果耳塞不适合您的耳型，您可能无法听到重低音。为了享受更佳音质，请更换耳塞尺寸，或调整耳塞的位置以舒适贴合您的耳朵。如果耳塞与您的耳形不匹配，请尝试其它尺寸的耳塞。通过查看内部的颜色来确认耳塞尺寸（见图 B-①）。当您更换耳塞时，请将其牢固地安装在耳机上以防止耳塞脱落落在您的耳朵内。

耳塞尺寸（内部颜色）

小		大
S (橙色)	M (绿色)	L (浅蓝色)

拆下耳塞（见图 B-②）

握住耳机，然后扭转拉出耳塞。

提示

如果耳塞较滑无法拆下，请用柔软干布将其包住。

装上耳塞（见图 B-③）

将耳塞的内部推入耳机，直到耳机的突出部分被完全包住。

清洁耳塞

从耳机上拆下耳塞，用中性清洁剂清洗。

规格

类型：	封闭式，动态
驱动单元：	9 mm (CCA W)，圆顶型
功率处理容量：	100 mW(IEC*)
阻抗：	1 kHz 时 16 Ω
灵敏度：	102 dB/mW
频率响应：	6 - 23000 Hz
导线：	1.2 m，绞合线 Y 型
插头：	镀金 L 形立体声迷你插头
质量：	约 8 g，不包括导线

附件

耳塞 (S (2), M (2), L (2))，使用说明书 (1)

* IEC = 国际电工委员会

设计和规格如有变更，恕不另行通知。

注意事项

- 请始终保持耳机清洁，尤其是橡胶耳塞内部（见图 C）。如果灰尘或耳垢进入耳塞，聆听效果可能不佳。
- 戴着耳机以高音量收听可能会影响您的听力。为了交通安全，请勿在驾车或骑车时使用。
- 耳塞可能会由于长期存放或使用而老化。
- 将耳塞牢固地安装在耳机上。如果耳塞意外脱落并留在耳内，可能会造成伤害。
- 使用耳机前，建议摘下耳环或穿耳饰。
- 切勿过度弯曲耳夹。如果弯曲超过 90 度，则可能断裂。

静电注意事项

在特别干燥的空气条件下，耳朵可能会感到轻微刺痛。这是由于体内积聚的静电所致，而非耳机故障。穿着天然材料制成的衣服可将此影响减到最少。

其它颜色的选购替换耳塞可以从您附近的 Sony 经销商处订购。

For China Market Only:

制造商：索尼公司
地址：日本国东京都港区港南1-7-1
总经销商：索尼（中国）有限公司
地址：中国北京市朝阳区东三环北路霞光里18号佳程大厦A座25层
原产地：泰国
出版日期：2010年4月

产品中有毒有害物质或元素的名称及含量

使用环境条件：5度~35度

(○：不含有，×：含有)

部件名称	有毒有害物质或元素					
	铅 (Pb)	汞 (Hg)	镉 (Cd)	六价铬 (Cr (VI))	多溴联苯 (PBB)	多溴二苯醚 (PBDE)
外壳	×	○	○	○	○	○
附件	○	○	○	○	○	○

○：表示该有毒有害物质在该部件所有均质材料中的含量均在 SJ/T11363-2006 标准规定的限量要求以下。

×：表示该有毒有害物质至少在该部件的某一均质材料中的含量超出 SJ/T11363-2006 标准规定的限量要求。



A

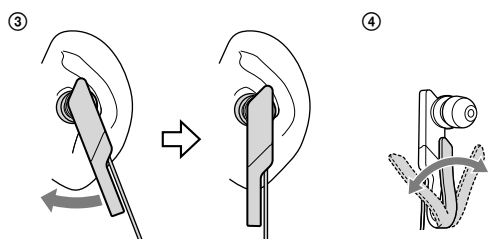
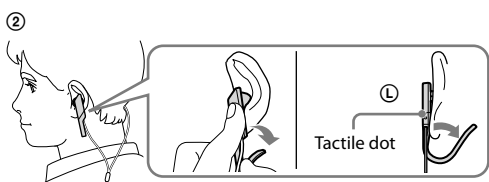
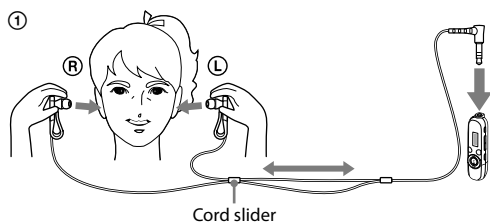

B

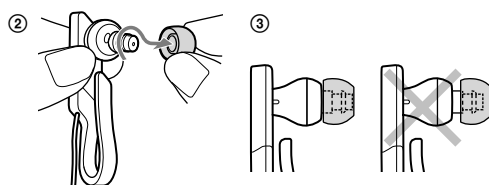
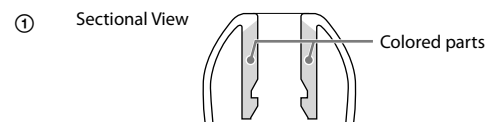

C

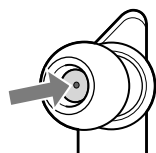

English

Stereo headphones

Features

- Ear-clip design for secure fit.
- Neodymium magnets deliver clear and powerful sound.
- Hybrid silicone rubber earbuds for comfort and secure fit.
- Cord slider to prevent tangled cords.

How to use

Wearing the headphones (see fig. A)

- 1 Wear the earbud marked R in your right ear and the one marked L in your left ear (see fig. A-1).**
- 2 Hook the headphones around your ears (see fig. A-2).**
There is a tactile dot on the unit marked L to distinguish the left side.
- 3 Clip around your ear lobes by rotating the headphones (see fig. A-3).**
- 4 Adjust the earbuds to comfortably fit your ears. Move the clip as shown in the figure (A-4) for a comfortable fit.**

How to use the cord slider (see fig. A-1)

Move up and down to change the split position of the cord. After you use the headphones, keep them with the cord slider high positioned to avoid entangling the cord.

How to install the earbuds correctly (see fig. B)

If the earbuds do not fit your ears correctly, low-bass sound may not be heard. To enjoy better sound quality, change the earbuds to another size, or adjust the earbuds position to sit on your ears comfortably and fit your ears snugly. If the earbuds do not fit your ears, try another size. Confirm the size of the earbuds by checking color inside (see fig. B-1).

When you change the earbuds, turn to install them firmly on the headphones to prevent the earbud from detaching and remaining in your ear.

Earbud sizes (inside color)

Small		Large
S (Orange)	M (Green)	L (Light blue)

To detach an earbud (see fig. B-2)

While holding the headphone, twist and pull the earbud off.

Tip

If the earbud slips and cannot be detached, wrap it in a dry soft cloth.

To attach an earbud (see fig. B-3)

Push the parts inside of the earbud into the headphone until the projecting part of the headphone is fully covered.

Cleaning the earbuds

Remove the earbuds from the headphones, and wash them with a mild detergent solution.

Specifications

Type:	Closed, dynamic
Driver unit:	9 mm (CCAW adopted), dome type
Power handling capacity:	100 mW (IEC*)
Impedance:	16 Ω at 1 kHz
Sensitivity:	102 dB/mW
Frequency response:	6 – 23,000 Hz
Cord:	1.2 m (47 1/4 in), Litz cord
Plug:	Y-type Gold-plated L-shaped stereo mini plug
Mass:	Approx. 8 g (0.28 oz) without cord

Supplied accessories

Earbuds (S (2), M (2), L (2)), Operating Instructions (1)

* IEC = International Electrotechnical Commission

Design and specifications are subject to change without notice.

Precautions

- Please keep your headphones clean at all times especially inside the rubber earbud (see fig. C).
- If any dust or ear wax inside the earbud, you may experience some listening difficulties.
- Listening with headphones at high volume may affect your hearing. For traffic safety, do not use while driving or cycling.
- The earbuds may deteriorate due to long-term storage or use.
- Install the earbuds firmly onto the headphones. If an earbud accidentally detaches and is left in your ear, it may cause injury.
- It may be advisable to remove earrings or pierced accessories before using the headphones.
- Do not bend the ear-clip excessively. If it is bent 90 degrees or more, it may break.

Note on static electricity

In particularly dry air conditions, mild tingling may be felt on your ears. This is a result of static electricity accumulated in the body, and not a malfunction of the headphones. The effect can be minimized by wearing clothes made from natural materials.

Optional replacement earbuds in other colours can be ordered from your nearest Sony dealer.