

Installing the rotary remote

Notes

- Choose the mounting location carefully so that the rotary remote will not interfere with operating the car.
- Do not install the rotary remote in a place where it may jeopardize the safety of the (front) passenger in anyway.
- When installing the rotary remote, be sure not to damage the electrical cables etc. on the other side of the mounting surface.
- Avoid installing the rotary remote where it may be subject to high temperatures, such as from direct sunlight or hot air from the heater etc.

Example of a mounting location

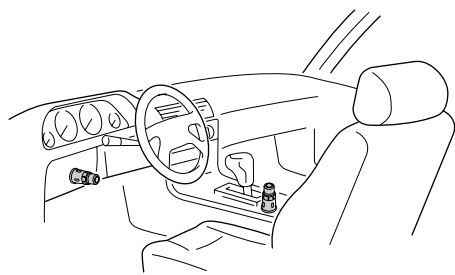

1 Choose the exact location for the rotary remote to be mounted, then clean the mounting surface.

Dirt or oil impair the adhesive strength of the double-sided adhesive tape.

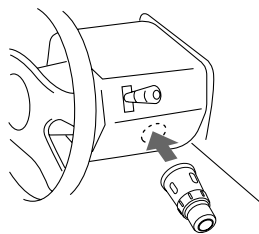

2 Mark two positions for the supplied screws. Use the screw holes on the mounting hardware to mark the positions.

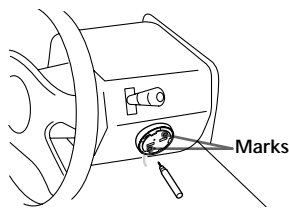

3 Remove the steering wheel column cover, and drill 2 mm (3/32 in.) diameter holes where you have marked.

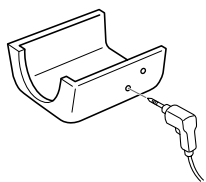

4 Warm the mounting surface and the double-sided adhesive tape on the mounting hardware to the temperature of 20°C (68°F) to 30°C (86°F), and attach the mounting hardware onto the mounting surface by applying even pressure. Then screw it down with the supplied screws ⑧.

Attach a piece of heavy duty tape etc. on the other side of the mounting surface to cover the protruding tips of the screws so that they will not interfere with the electrical cables etc. inside the steering wheel column.

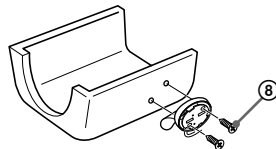

Heavy duty tape etc.

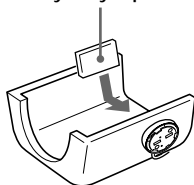

5 After installing the steering wheel column cover, attach the rotary remote to the mounting hardware by aligning the four holes on the bottom of the rotary remote to the four catches on the mounting hardware and sliding the rotary remote until it locks into place as illustrated.

Note
If you are mounting the rotary remote to the steering wheel column, make sure that the protruding tips of the screws on the inner surface of the column do not in anyway hinder or interfere with the movement of the rotating shaft, operative parts of the switches or the electrical cables etc. inside the column.

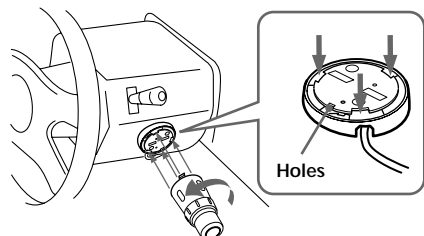

Installing the Wireless Remote

About the installation site

Before installing the remote, make sure that the remote can be taken out easily from the location you are considering and it does not interfere with the movement of any car-control systems such as shift lever or emergency brake.

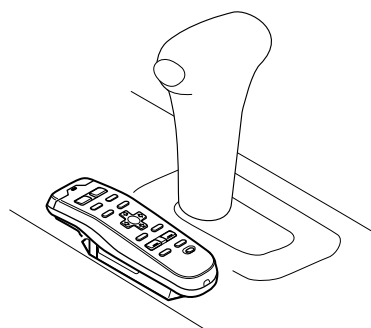

Wipe the surface where you plan to install the remote holder, then attach the holder with double-sided tape.

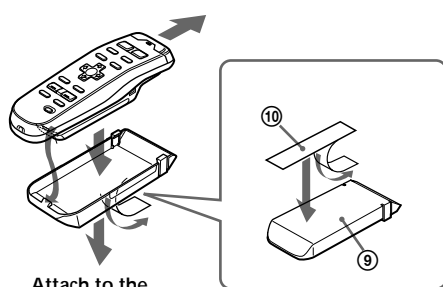

Notes

- Direct sunlight may affect the system's ability to receive infrared signals from the remote. If this happens, move the remote closer to the remote control sensor of the system.
- To prevent deformation due to heat, do not install the remote in a place subject to direct sunlight.
- When parking your car, put the remote somewhere, such as the glove compartment, that is away from direct sunlight to prevent deformation due to heat.

FM/AM Compact Disc Player

Installation/Connections



CDX-C90

Sony Corporation © 1998 Printed in Japan

Parts for installation and connections

The numbers in the list are keyed to those in the instructions.

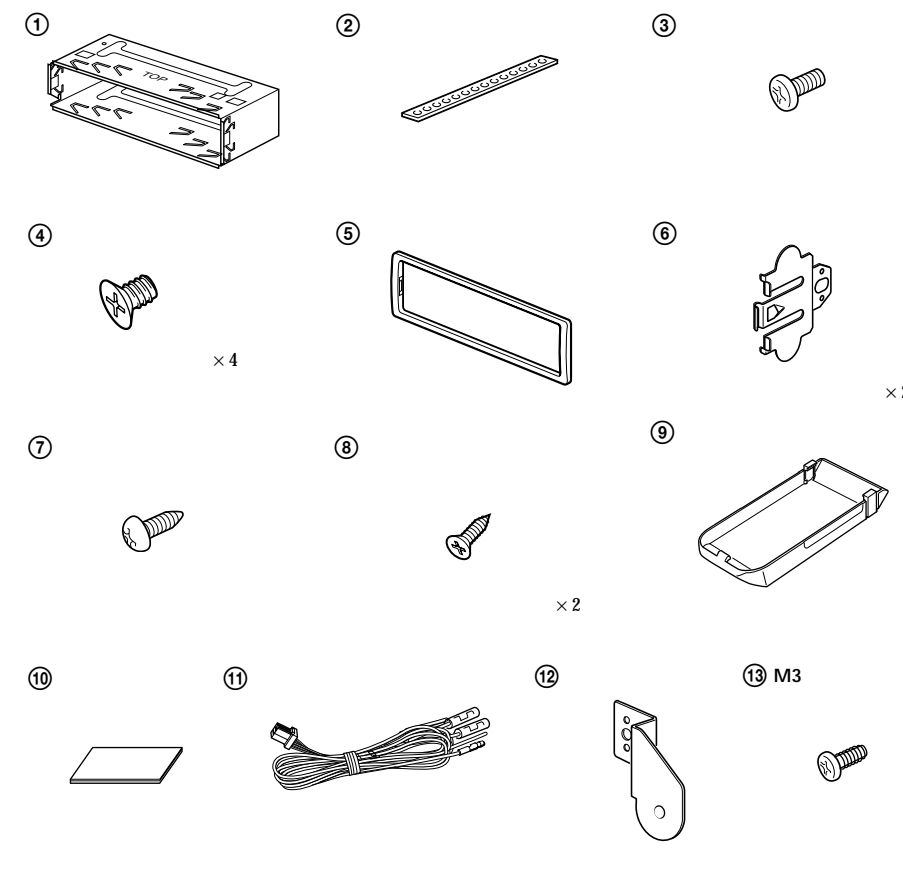

Caution

Cautionary notice for handling the bracket ①. Handle the bracket carefully to avoid injuring your fingers.

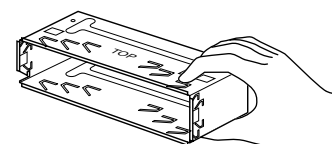

Installation

Precautions

- Do not tamper with the four holes on the upper surface of the unit. They are for tuner adjustments to be done only by service technicians.
- There must be a distance of at least 5 cm (2 in.) between the unit and the car's shift lever to open and close the front panel. Install the unit so that it does not interfere with gear shifting and other driving operations.
- Choose the installation location carefully so that the unit does not hamper the driver during driving.
- Avoid installing the unit where it would be subject to high temperatures, such as from direct sunlight or hot air from the heater, or where it would be subject to dust, dirt or excessive vibration.
- Use only the supplied mounting hardware for a safe and secure installation.

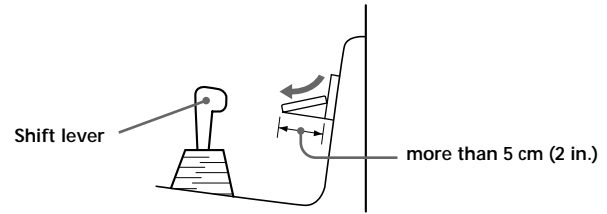

Mounting angle adjustment

Adjust the mounting angle to less than 60°.

How to detach and attach the front panel

Before installing the unit, detach the front panel.

A To detach

Before detaching the front panel, be sure to press OFF first. Press RELEASE to open up the front panel. Then slide the front panel a little to the left, and pull it off towards you.

B To attach

Align part ① of the front panel to part ② of the unit as illustrated, and push until it clicks.

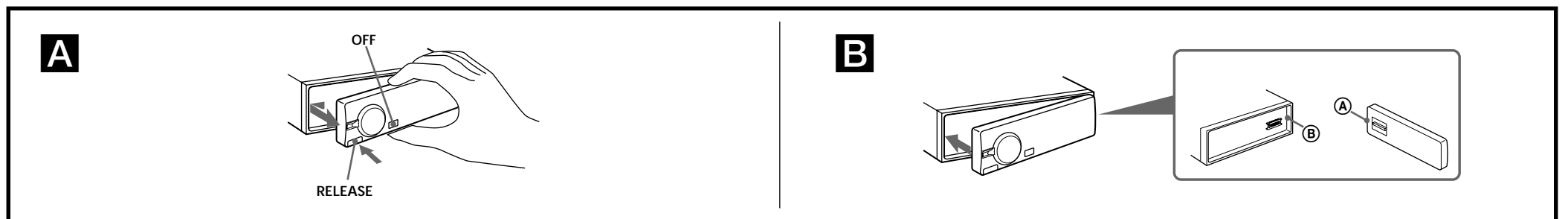

Mounting example

Installation in the dashboard

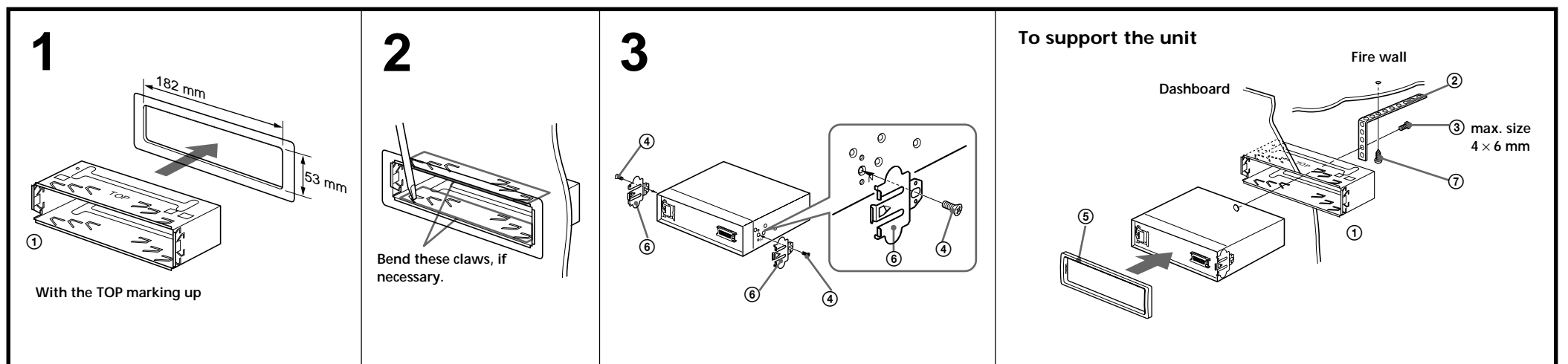

Mounting the unit in a Japanese car

You may not be able to install this unit in some makes of Japanese cars. In such a case, consult your Sony dealer.

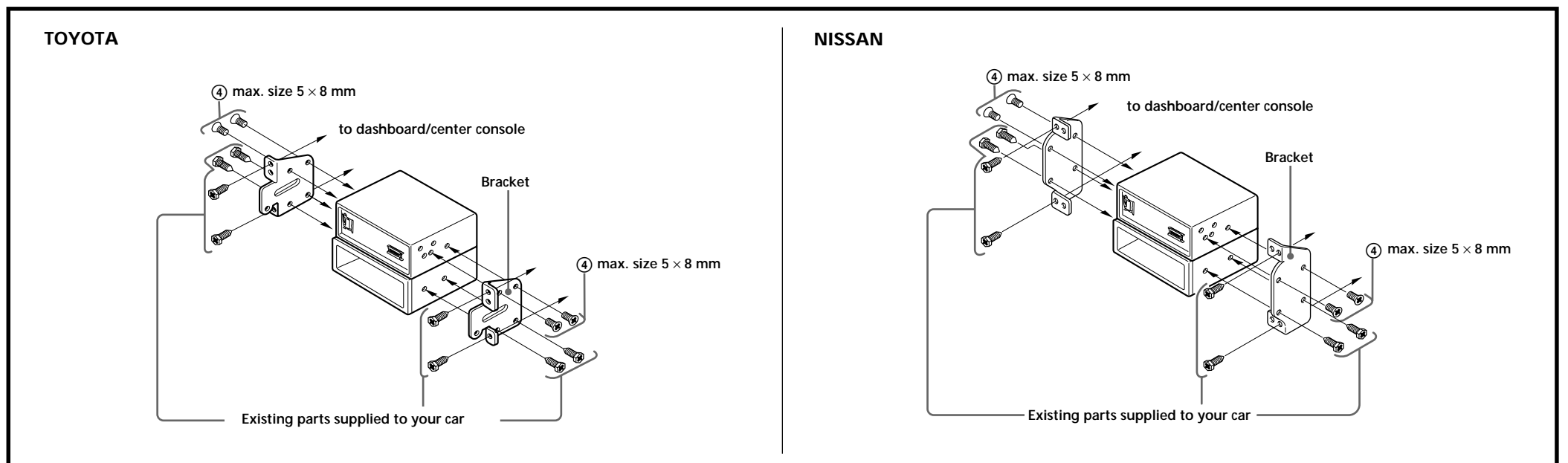

Notes
To prevent malfunction, install only with the supplied screws ④.

Connections

Caution

- This unit is designed for negative ground 12 V DC operation only.
- Before making connections, disconnect the ground terminal of the car battery to avoid short circuits.
- Connect the yellow and red power input leads only after all other leads have been connected.
- Be sure to connect the red power input lead to the positive 12 V power terminal which is energized when the ignition key is in the accessory position.
- Run all earth wires to a common earth point.
- The use of optical instruments with this product will increase eye hazard.

Reset button

When the installation and connections are over, be sure to press the reset button with a ball-point pen etc.

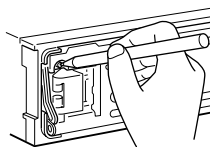

When making a digital connection

To connect a unit with an optical cable, connect the optical cable (optional) to the optical adapter (optional), and plug the adapter into the special socket on the rear of the unit. Then set the Digital out to "on". To set the Digital out to "on" or "off", refer to the "Initial settings" in the Operating Instructions.

Notes

- The Digital out is factory-set to off.
- If the Digital out is not correctly set, the unit will work without producing a sound.

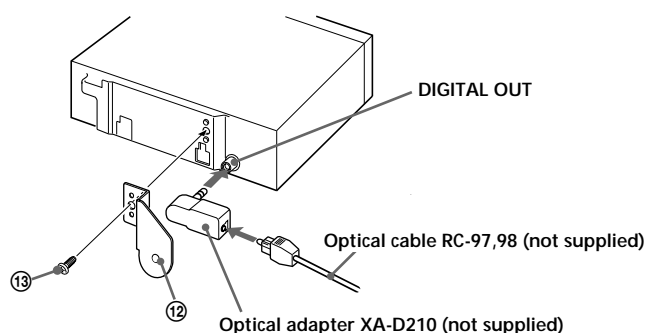

Equipment used in illustrations (not supplied)

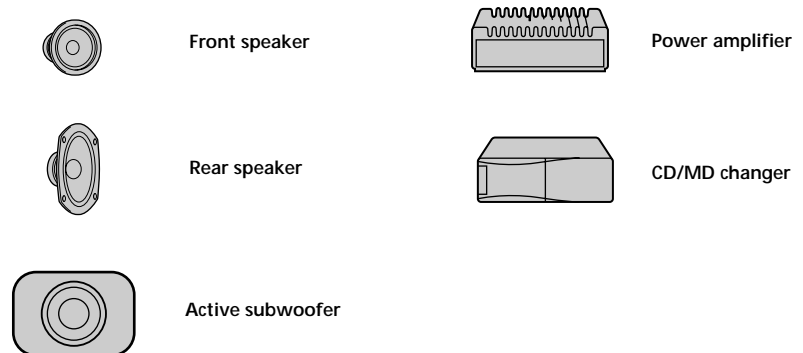

Connection diagram

Example 1

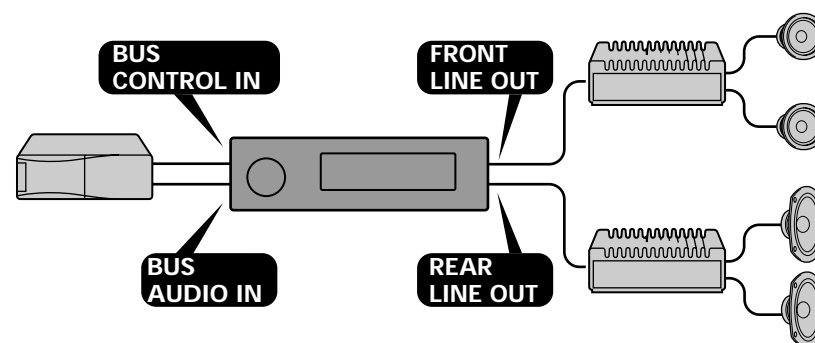

Example 2

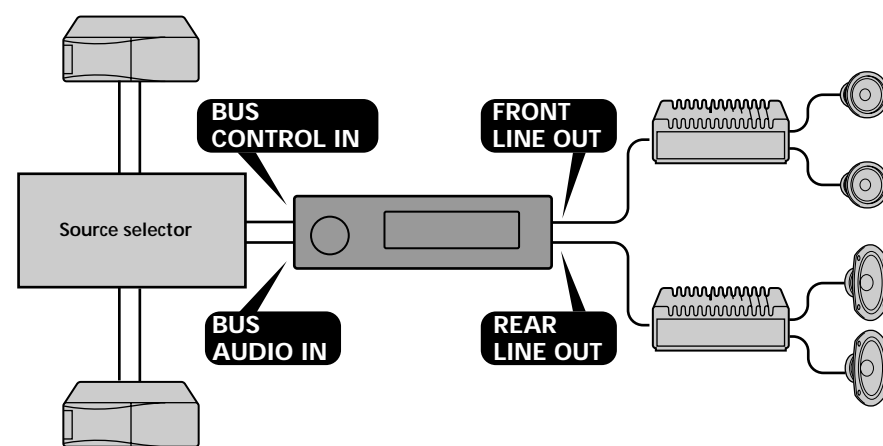

For connecting two or more changers, the source selector XA-C30 (optional) is necessary.

Example 3

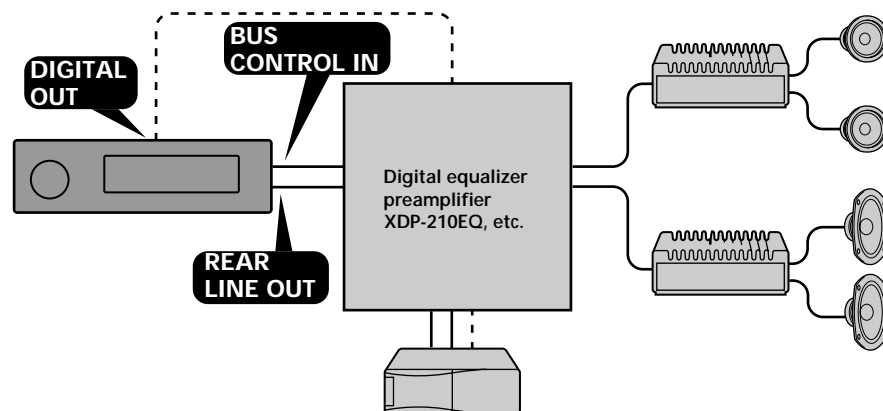

Connection example

* When connecting a digital equalizer preamplifier XDP-210EQ, refer to the Installation/Connections manual XDP-210EQ.

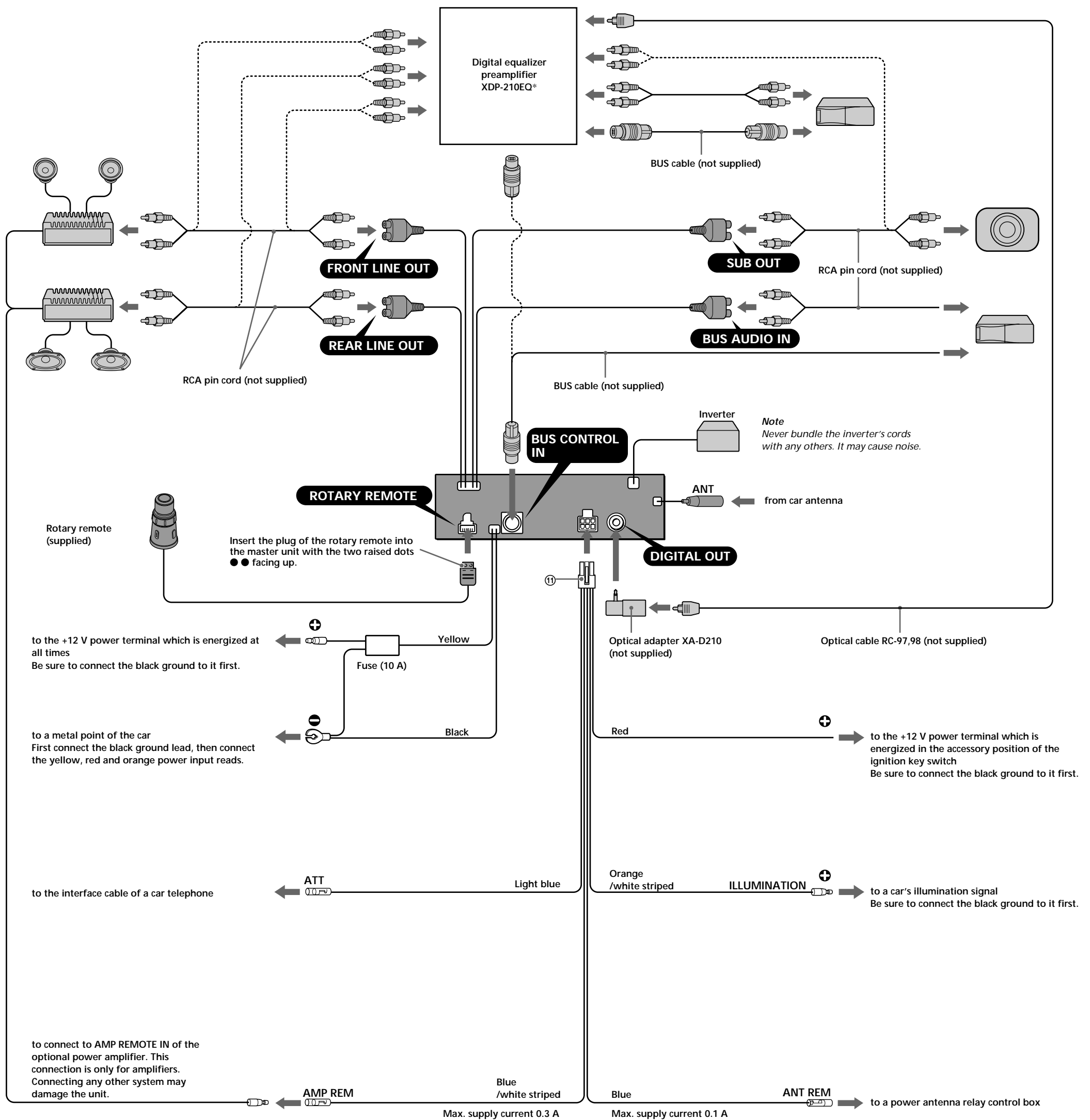

Inverter

- Install the inverter far away from the unit using double-sided adhesive tape or something similar.
- Do not bundle the inverter's cord with a pincord or other connecting cord.
- Be sure not to mount the inverter under a mat or in a place exposed to splashing water of air conditioner. It may cause electric shock or damage to the unit.

Note

If the inverter's cord is pinched, the display indications may not appear.

Using the optional power amplifier

This master unit, when connected to an optional power amplifier, is designed to reproduce high quality sound. To make the best use of the optional power amplifier, follow the steps below.

- Use the dial to set the master unit's volume to the highest level possible, depending on the optional power amplifier. This improves the harmonic distortion and signal-to-noise ratio.
- Use the power amplifier's LEVEL (GAIN) control to adjust the listening volume to a suitable level.